

SR7701 - KR7701

PORTAPACCO SPECIFICO - SPECIFIC HOLDER - PORTE-PAQUET SPÉCIFIQUE - SPEZIFISCHER TRÄGER - PORTA-EQUIPAJE ESPECÍFICO

KTM DUKE 125cc (2011)

N°	Descrizione	Caratteristiche	Codice	Quantità	
1	Supporto - Support - Support Halterung - Soporte	-	-	1	
2	Ponte Posteriore - Rear Bridge Pont Postérieure Verbindungsrohr - Puente Trasero	-	-	1	
3	Vite - Screw Vis - Schraube Tornillo	TEF M6x16	-	2	
4	Vite - Screw Vis - Schraube Tornillo	TEF M6x35	-	2	
5	Vite - Screw Vis - Schraube Tornillo	TEF M8x30	-	4	
6	Distanziale - Spacer Entretoise - Distanzstueck Distanciador	Ø16x12 in tubo	V700	4	
7	Distanziale - Spacer Entretoise - Distanzstueck Distanciador	Ø16x24 ribassato Ø10x5.5 foro 6.5mm	V832	2	
8	Componenti originali - Original parts Parties originales - Original bauteile Componentes originales	-	-	-	

SR7701 - KR7701

PORTAPACCO SPECIFICO - SPECIFIC HOLDER - PORTE-PAQUET SPÉCIFIQUE - SPEZIFISCHER TRÄGER - PORTA-EQUIPAJE ESPECÍFICO

KTM DUKE 125cc (2011)

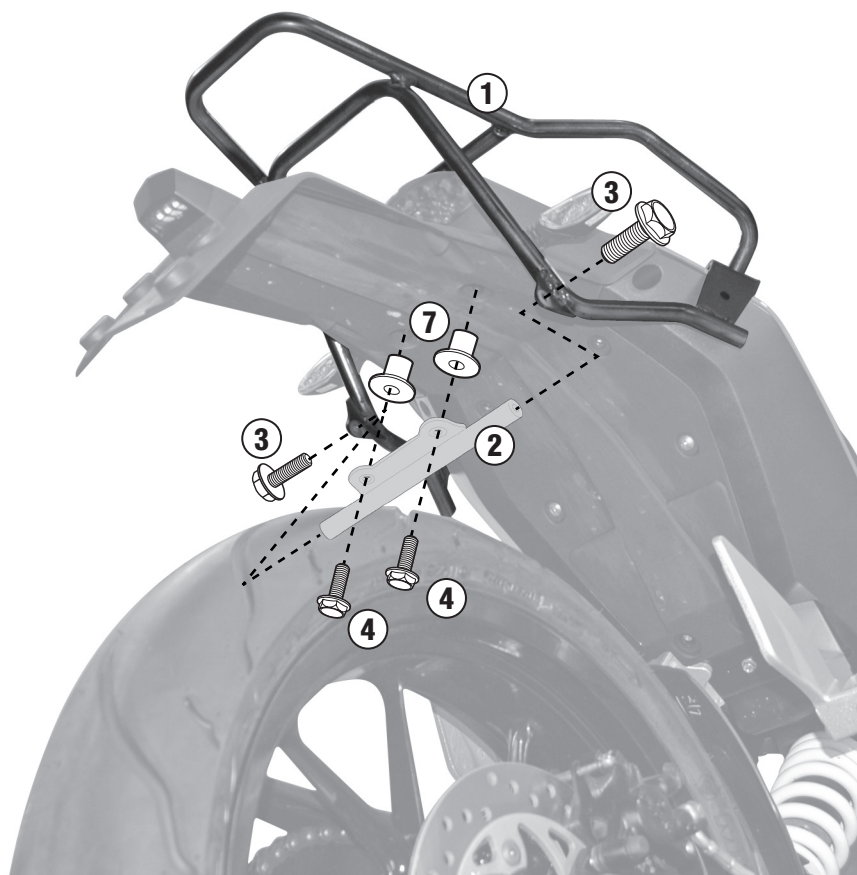
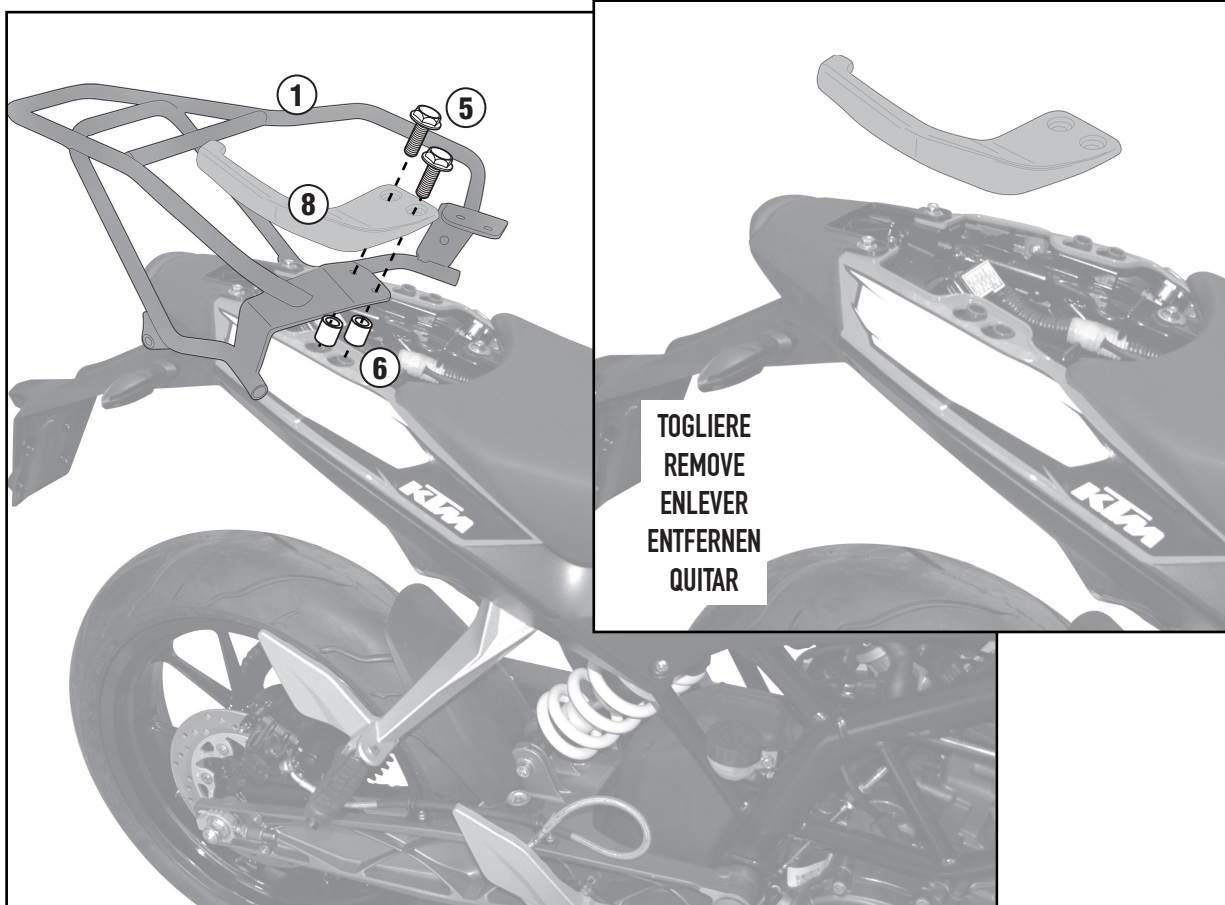

ISTRUZIONI DI MONTAGGIO - MOUNTING INSTRUCTIONS
INSTRUCTIONS DE MONTAGE - BAUANLEITUNG - INSTRUCCIONES
DE MONTAJE